

## NK-401 Ear-Hold Type Sound Collector Instruction manual

Thank you very much for purchasing our sound collector.

- This product is a sound collector, and is not a hearing aid as a medical device.
- Please read instruction manual carefully and use the device properly and safely.
- Please read "Precautions for use and storage" before using the product.
- Please keep the instruction manual in a safe place and use it whenever necessary.

Manufacturing and sales company,  
株式会社日健 (NIKEN CO.,LTD)

Support center : support@nikens.co.jp

URL : www.nikens.co.jp

### For first-time users

It is difficult to hear what is being said when you first put on a sound collector. Please continue to use the device every day to the extent that you do not get tired. Gradually get used to the device by increasing the duration of use in the following four stages.

1. Listen to your own voice in a quiet place.
2. Talk with your family or friends in a quiet place.
3. Listen to the TV (news channels) at the same volume as the people around you.

Try not to turn up the volume too high at the beginning, as it may cause fatigue until you get used to it. Your family members should also warmly support you until you become proficient in using a sound collector. The cooperation and thoughtfulness of your family and others around you will be most encouraging. If you cannot hear well, if the beeping does not stop, or if you are bothered by the beeping sound when wearing the device

1. If the earpiece is not inserted correctly into the ear canal, a beeping sound (howling) may occur. In this case, please adjust the position and direction of the sound collector.
2. Replace the earpiece with one that fits your ear canal.
3. It takes about one month to get used to the sound after starting to wear the sound collector, although it varies from person to person.

### Please read below before using the device.

- If the device is damaged, cracked, or defective, stop using it and contact our support center for repair. If you continue to use the product as it is, it may cause electric shock, fire, or injury.
- Do not attempt to disassemble, modify, or repair the product by yourself. Doing so may result in fire or injury.
- Do not use the device at a higher volume than necessary. This may cause damage to your ears.

### Precautions during use

1. If the size of the earpiece does not fit, replace the earpiece with another one included that fits you.
2. Do not pull the cord to adjust the position of the main unit. Doing so may cause the cord to break.
3. When removing the unit from the charging stand, be sure to hold the unit, not the cord.
4. Keep hair away from the microphone as much as possible to avoid noise.
5. When not in use, be sure to turn the power off before storing.
6. If you are not going to use this product for a while, clean it well and store it in a cool, dark place.
7. This product is not waterproof, so do not get it wet.

### Precautions for use (Must be followed)

In order to prevent harm to the customer or damage to property, be sure to observe the following

This product is a sound collector to assist your hearing. Do not use it for any other purpose.

The following is an explanation of the degree of harm or damage that may result from improper use of this product.

- This product is intended for home use only and should not be used for business purposes. It may cause damage and is not covered by warranty.
- Do not use this product near medical equipment (operating room, intensive care unit, etc.).
- Do not use this product when undergoing MRI (Magnetic Resonance Imaging) diagnosis or treatment using equipment that uses electromagnetic waves.
- Do not use this product in conjunction with a mobile phone or simple cell phone. This may create noises or make the sound smaller.
- Store this device in a flat and dry place. Not doing so may cause malfunction.
- Do not use this product during strenuous exercise, or it may be damaged if dropped. Pay special attention to it at Railroad crossings and pedestrian crossings.

### Names of parts

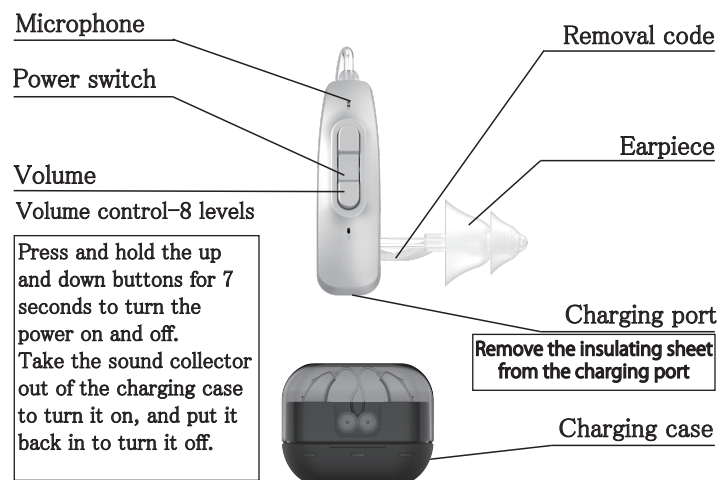

### Accessories

- Two sound collectors
- Earpiece set
- Charging case
- Cleaning brush set
- Charging cable
- Instruction manual
- AC-USB adapter

### How to use



1. Charge the battery first after purchase.



2. While charging, the left/right side charging and the middle charging case light up, and will turn off when charging is complete.



3. Remove the main unit from the charging case to turn on the power. When the main unit of the sound collector is returned, the power is turned off.



4. Select the earpiece size that does not leave a gap between the ear and ear hole, and insert it firmly.

## How to use



5. Set the volume control to the minimum position. There are eight levels of volume.

6. There may be some howling (beeping) when you put it on, but it will disappear when you put it on correctly.



7. Place the sound collector on your ear. Press the volume control to adjust the sound volume gradually.

8. When removing the sound corrector from your ear, hold the removal cord and remove it slowly.

## Caution

In the following cases, even within the warranty period, the product will be subject to repair or replacement for a fee.

1. Replacement of consumables such as accessories.
2. In the event of malfunction or damage caused by loading on a vehicle or ship.
3. In the event of malfunction or damage caused by applications other than general household use (such as commercial use).
4. Failure to follow the instructions provided in this manual.
5. If this manual is missing, or if the words in this manual have been rewritten.
6. In the event of malfunction or damage due to misuse, improper repair, or modification.
7. In the event of malfunction or damage due to transportation, dropping, wetting with water, etc. after delivery.
8. In the event of malfunction or damage due to fire, pollution, abnormal voltage, earthquake, lightning, wind, flood, or other natural disasters.
9. In the event of malfunction or damage caused by use under severe conditions.
10. In case the cause of failure is other than this product.

## For first-time users

It is difficult to hear what is being said when you first put on a sound collector. Please continue to use the device every day to the extent that you do not get tired. Gradually get used to the device by increasing the duration of use in the following four stages.

1. Listen to your own voice in a quiet place.
2. Talk with your family or friends in a quiet place.
3. Listen to the TV (news channels) at the same volume as the people around you.
4. Talk with four or five other people in a quiet place.

Try not to turn up the volume too high at the beginning, as it may cause fatigue until you get used to it. Your family members should also warmly support you until you become proficient in using a sound collector. The cooperation and thoughtfulness of your family and others around you will be most encouraging.

If you cannot hear well, if the beeping does not stop, or if you are bothered by the beeping sound when wearing the device

1. If the earpiece is not inserted correctly into the ear canal, a beeping sound (howling) may occur. In this case, please adjust the position and direction of the sound collector.
2. Replace the earpiece with one that fits your ear canal.
3. It takes about one month to get used to the sound after starting to wear the sound collector, although it varies from person to person.

## Repair and Replacement Policy

1. This product will be repaired or exchanged free of charge in the event of malfunction or natural failure for a period of one year from the date of purchase.
2. In the event of a malfunction or natural failure within the warranty period, please contact our support center.
3. We are not responsible for any incidental damages caused by the failure of this product.
4. This manual will not be reissued, so please keep it in a safe place.

## Care and Storage

Before and after use, remove the earpiece and clean it with the supplied cleaning brush.

● Clean the earpiece time to time, in order to prevent earwax and other debris from clogging the earpiece. If the earpiece is clogged with dust, it may make it difficult to hear the sound.

● When wiping the unit, use a clean, dry cloth. If the unit is heavily soiled, wipe it with a mild detergent solution and wring it out.

● Do not store the device in the following places.

- Places with extremely high or low temperatures
- Near a heat source or fire
- Outdoors or in direct sunlight
- Places where children and pets can reach
- Places where there is a lot of dust or humidity
- Near hazardous materials
- Places exposed to oil smoke or steam
- Near slippery objects (grease, snow, oil, unseasoned paint, etc.)

## Warranty

This product is warranted against defects in materials and workmanship for a period of one (1) year from the date of purchase, at which time the product will be repaired or replaced free of charge in accordance with the Repair and Replacement Policy. This warranty does not limit your legal rights, and you will not be liable for any incidental damages resulting from the failure of this product, such as replacement or repair after the warranty period has expired.

Date of purchase \_\_\_\_\_

The store you purchased this product \_\_\_\_\_

Your name \_\_\_\_\_

Home address \_\_\_\_\_